

## USB 2.0 to IDE or SATA Adapter Cable



*Actual product may vary from photos*

### User Manual SKU#: USB2SATAIDE

For the latest information and specifications visit  
[www.startech.com/USB2SATAIDE](http://www.startech.com/USB2SATAIDE)

# Compliance Statements

## FCC Compliance Statement

This equipment has been tested and found to comply with the limits for a Class B digital device, pursuant to part 15 of the FCC Rules. These limits are designed to provide reasonable protection against harmful interference in a residential installation. This equipment generates, uses and can radiate radio frequency energy and, if not installed and used in accordance with the instructions, may cause harmful interference to radio communications. However, there is no guarantee that interference will not occur in a particular installation. If this equipment does cause harmful interference to radio or television reception, which can be determined by turning the equipment off and on, the user is encouraged to try to correct the interference by one or more of the following measures:

- Reorient or relocate the receiving antenna
- Increase the separation between the equipment and receiver
- Connect the equipment into an outlet on a circuit different from that to which the receiver is connected
- Consult the dealer or an experienced radio/TV technician for help

## Industry Canada Statement

This Class B digital apparatus complies with Canadian ICES-003.  
Cet appareil numérique de la classe [B] est conforme à la norme NMB-003 du Canada.

CAN ICES-3 (B)/NMB-3(B)

## Use of Trademarks, Registered Trademarks, and other Protected Names and Symbols

This manual may make reference to trademarks, registered trademarks, and other protected names and/or symbols of third-party companies not related in any way to StarTech.com. Where they occur these references are for illustrative purposes only and do not represent an endorsement of a product or service by StarTech.com, or an endorsement of the product(s) to which this manual applies by the third-party company in question. Regardless of any direct acknowledgement elsewhere in the body of this document, StarTech.com hereby acknowledges that all trademarks, registered trademarks, service marks, and other protected names and/or symbols contained in this manual and related documents are the property of their respective holders.

# Safety Statements

## Safety Measures

- Wiring terminations should not be made with the product and/or electric lines under power.
- Cables (including power and charging cables) should be placed and routed to avoid creating electric, tripping or safety hazards.

## Mesures de sécurité

- Les terminaisons de câblage ne doivent pas être effectuées lorsque le produit et/ou les câbles électriques sont sous tension.
- Les câbles (y compris les câbles d'alimentation et de chargement) doivent être placés et acheminés de façon à éviter tout risque électrique, de chute ou de sécurité

## 安全対策

- 電源が入っている状態の製品または電線の終端処理を行わないでください。
- ケーブル(電源ケーブルと充電ケーブルを含む)は、適切な配置と引き回しを行い、電気障害やつまづきの危険性など、安全上のリスクを回避するようにしてください。

## Misure di sicurezza

- I terminali dei fili elettrici non devono essere realizzate con il prodotto e/o le linee elettriche sotto tensione.
- I cavi (inclusi i cavi di alimentazione e di ricarica) devono essere posizionati e stesi in modo da evitare pericoli di inciampo, rischi di scosse elettriche o pericoli per la sicurezza.

## Säkerhetsåtgärder

- Montering av kabelavslutningar får inte göras när produkten och/eller elledningarna är strömförda.
- Kablar (inklusive elkablar och laddningskablar) ska dras och placeras på så sätt att risk för snubblingsolyckor och andra olyckor kan undvikas.

# Table of Contents

<b>Compliance Statements .....</b>	<b>1</b>
<b>Safety Statements .....</b>	<b>2</b>
<b>Product Diagram .....</b>	<b>4</b>
Front View .....	4
Power Adapter .....	5
Connector .....	6
<b>Introduction .....</b>	<b>7</b>
Package Contents .....	7
System Requirements.....	7
<b>Installation .....</b>	<b>8</b>
Connect a SATA Hard Drive.....	9
Connecting a 40/44-pin IDE Drive .....	10
Connect a SATA Hard Drive to the Power Adapter.....	11
Connect a 40-pin IDE Hard Drive to the Power Adatper.....	12
Connect the Hard Drive Adapter to the Host Computer .....	13
Removing Connected Drives .....	14
<b>Technical Specifications .....</b>	<b>15</b>

## Product Diagram

### Front View

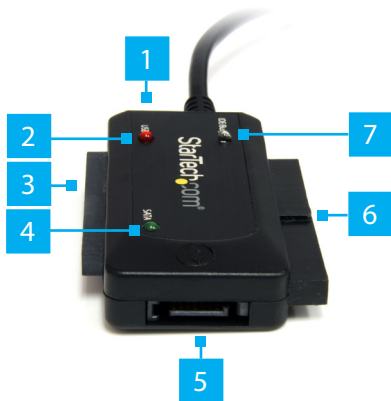

1	<i>DC Power Port</i>	5	<i>SATA Port</i>
2	<i>USB-A Link LED</i>	6	<i>40-Pin IDE Connector</i>
3	<i>44-Pin IDE Connector</i>	7	<i>IDE Detect/Activity LED</i>
4	<i>SATA Detect/Activity LED</i>		

## Power Adapter



<b>1</b>	<i>Power LEDs (x 2)</i>	<b>4</b>	<i>LP4 Power Connector</i>
<b>2</b>	<i>Power Switch (x 2)</i>	<b>5</b>	<i>SATA Power Connector</i>
<b>3</b>	<i>Power Connector</i>		

## Connector



1

*USB-A Connector*

## Introduction

You can use the Adapter to copy, back up, or transfer large amounts of data from one drive to another.

## Package Contents

- USB 2.0 to SATA/IDE Adapter x 1
- SATA Data Cable x 1
- Power Adapter Breakout Cable x 1
- Universal Power Adapter (NA/JP, UK, EU, AU) x 1
- User Manual x 1

## System Requirements

- Available USB 2.0 port
- Available AC electrical outlet



## Installation

**Warnings:** Do not disconnect any cables or power sources while the connected hard drive(s) is/are active. This can result in data loss and possible damage to the hard drive. To avoid this, please follow the steps outlined in the section entitled [Removing Connected Drives](#).

Please ensure that the hard drive(s) has(have) been connected to the Adapter prior to connecting the Adapter to the Host Computer.

Hard drives and storage enclosures require careful handling, especially when being transported. Be sure that you are properly grounded by wearing an anti-static strap when handling computer components or discharge yourself of any static electricity built-up by touching a large grounded metal surface (such as the computer case).

**Note:** If you are using two IDE hard drives concurrently, one of the drives must be set to act as a Master Drive and the other as Slave Drive. If you are using a 3.5" IDE hard drive and a SATA hard drive together, the IDE hard drive must be set to act as a Slave Drive. For further information, consult the documentation that accompanied the hard drive(s).

## Connect a SATA Hard Drive

1. Insert one of the SATA Data Cable Connectors (included) into the SATA Port on the Adapter.



### *Connecting a SATA Data Cable to the SATA Port*

2. Insert the other SATA Data Cable Connector to the SATA data port on the SATA hard drive.

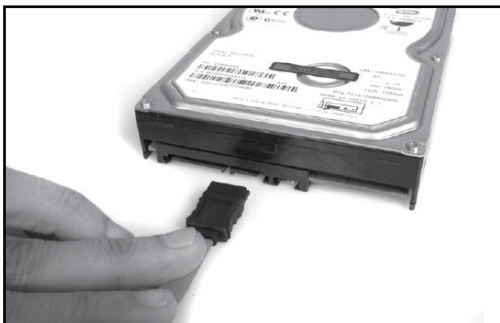

*Connecting the SATA Data Cable to the SATA Hard Drive*

## Connecting a 40/44-pin IDE Drive

1. Align the IDE Drive Interface on the Hard Drive with either the 40-Pin IDE Connector or the 44-Pin IDE Connector on the Adapter.
2. Insert the IDE Connector (40 or 44-pin) on the Adapter into the IDE Drive Interface on the Hard Drive. Ensure the drive is connected tightly to the Adapter.



*Connecting the IDE Connector*

## Connect a SATA Hard Drive to the Power Adapter

1. Insert the SATA Power Connector on the Power Adapter Breakout Cable into the SATA power port on the SATA hard drive.
2. Connect the Power Adapter Breakout Cable to the Universal Power Adapter.
3. Connect the Universal Power Adapter to an AC Electrical Outlet

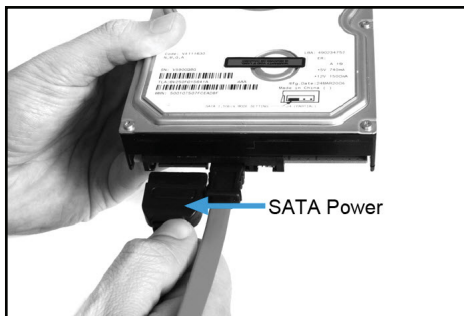

*Connecting the SATA Power Connector*

## Connect a 40-pin IDE Hard Drive to the Power Adatper

1. Insert the LP4 Power Connector on the Power Adapter Breakout Cable into the LP4 power port on the IDE hard drive.
2. Connect the Power Adapter Breakout Cable to the Universal Power Adapter.
3. Connect the Universal Power Adapter to an AC Electrical Outlet



*Connecting the LP4 Power Connector*

## Connect the Hard Drive Adapter to the Host Computer

**Note:** *If using a new/blank drive, it may need to be formatted before it can be used. Please consult the documentation for the operating system for details.*

1. Insert the USB-A Connector on the Adapter into a USB-A port on the Host Computer.
2. The operating system will detect the connected Adapter, and prepare the drives for use.

## Removing Connected Drives

**Warning:** Do not remove a connected hard drive while the drive is in use. To prevent data loss or damage to the drive(s), please follow the instructions below.

Removing a connected drive safely requires that the drive not be in use. To ensure that this is the case, you can remove the drive in one of the two following ways:

1. Click on the Safely Remove Hardware icon, in the taskbar, and select Safely Remove USB Mass Storage Device.
2. Following this, you will be notified that it is safe to remove the USB Mass Storage device:

## Technical Specifications

<b>Host Interface</b>	USB 2.0
<b>External Connectors</b>	15 pin SATA Power female x 1 4 pin Power (LP4) Female x 1 40 pin IDE Female x 1 44 pin IDE Female x 1 7 pin SATA Data male x 1 USB type A male x 1
<b>LEDs</b>	USB Link x 1 IDE Detect/Activity x 1 SATA Detect/Activity x 1
<b>Maximum Data Transfer Rate</b>	USB 2.0: 480Mbps
<b>Power Adapter</b>	12VDC, 2000mA
<b>Compatible Operating Systems</b>	Windows 2000/XP/Server 2003/Vista/Server 2008 R2/7 (32/64-bit), Mac OS 9/10, Linux



## Warranty Information

This product is backed by a two-year warranty.

For further information on product warranty terms and conditions, please refer to [www.startech.com/warranty](http://www.startech.com/warranty).

## Limitation of Liability

In no event shall the liability of StarTech.com Ltd. and StarTech.com USA LLP (or their officers, directors, employees or agents) for any damages (whether direct or indirect, special, punitive, incidental, consequential, or otherwise), loss of profits, loss of business, or any pecuniary loss, arising out of or related to the use of the product exceed the actual price paid for the product.

Some states do not allow the exclusion or limitation of incidental or consequential damages. If such laws apply, the limitations or exclusions contained in this statement may not apply to you.

## Hard-to-find made easy. At StarTech.com, that isn't a slogan. It's a promise.

StarTech.com is your one-stop source for every connectivity part you need. From the latest technology to legacy products — and all the parts that bridge the old and new — we can help you find the parts that connect your solutions.

We make it easy to locate the parts, and we quickly deliver them wherever they need to go. Just talk to one of our tech advisors or visit our website. You'll be connected to the products you need in no time.

Visit [www.startech.com](http://www.startech.com) for complete information on all StarTech.com products and to access exclusive resources and time-saving tools.

StarTech.com is an ISO 9001 Registered manufacturer of connectivity and technology parts. StarTech.com was founded in 1985 and has operations in the United States, Canada, the United Kingdom and Taiwan servicing a worldwide market.

### Reviews

Share your experiences using StarTech.com products, including product applications and setup, what you love about the products, and areas for improvement.

#### StarTech.com Ltd.

45 Artisans Cres.  
London, Ontario  
N5V 5E9  
Canada

FR: [startech.com/fr](http://startech.com/fr)

DE: [startech.com/de](http://startech.com/de)

#### StarTech.com LLP

2500 Creekside Pkwy.  
Lockbourne, Ohio  
43137  
U.S.A.

ES: [startech.com/es](http://startech.com/es)

NL: [startech.com/nl](http://startech.com/nl)

#### StarTech.com Ltd.

Unit B, Pinnacle  
15 Gowerton Rd.,  
Brackmills  
Northampton  
NN4 7BW  
United Kingdom

IT: [startech.com/it](http://startech.com/it)

JP: [startech.com/jp](http://startech.com/jp)